

Load Link with Wireless Remote Control

Applications

- Under hook crane weighing
- Measurements of cable tension
- Determination of loads in wire rope

The load link model KAK-F is a compact measuring device for the determination of loads in wire rope and cranes. With the assistance of shackles, hooks and master links the load link will be completed to a crane scale. The load link is equipped with RRF remote control unit operates at 868 MHz and allows complete control of the scale. The measuring data can be transferred to a PC. The load link operates independent of mains and its operation time, with a fully charged battery, amounts to at least 140 hours.



Features

- 1.0t to 100t capacities
- Accuracy class 0.2 %
- For use with standard lifting shackles
- Wireless data transmission
- Serial interface (RS232)
- Anodised aluminium alloy and stainless steel brushes
- Low weight

Application Example

Typical applications include the measurement of chain forces when connected off-key from the main crane lifting force. In this application the KAK-F is sending the individual tension of each chain to the remote display. The serial interface allows the direct communication with a PC or another large display. Through this measurement the user can ensure that no overload occurs in the individual chains during the operation. The remote control FFB 204 can be used in this case to control up to 4 load links.

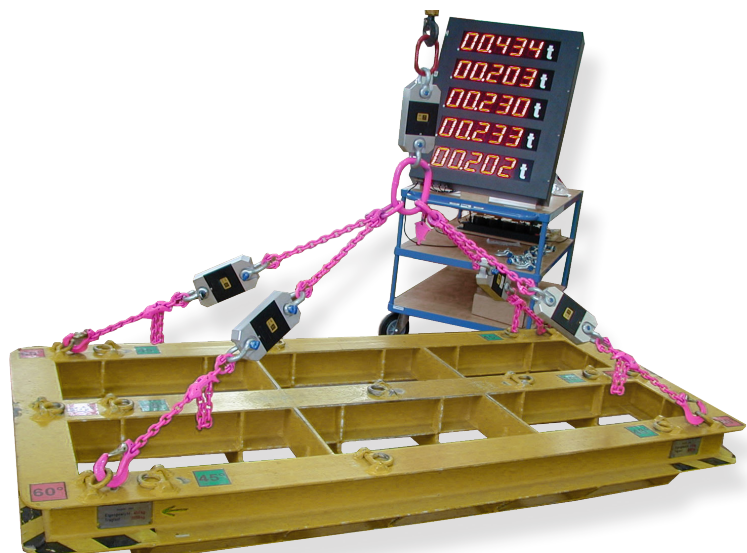

Specifications

Accuracy Class	% FSR	0.2
Rated load (F_{nom})	t	1/ 2.5/ 5/ 10/ 20/ 35/ 50/ 100
Maximum operating load (F_G)	% F_{nom}	150
Breaking load (F_B)	% F_{nom}	> 500
Reference temperature (T_{ref})	°C	+ 23
Rated temperature range ($B_{T,nom}$)	°C	-10 ... +40
Operating temperature range ($B_{T,G}$)	°C	-20 ... +70
Storage temperature range ($B_{T,s}$)	°C	-20 ... +70
Battery operating time	h	140 (20°C)
Environmental protection (EN 60529)		IP 54
Remote Control FFB 201		
Frequency	MHz	ISM-Band 868,3MHz
Transmission power	mW	10mW (7dBm)
Transfer quota		1 reading per 2s
Range in visual connection	m	approx. 40
Display in t		LCD, 5 digits
Figure height	mm	14
Figure step (at rated load)		0.5kg (1t), 1kg (2.5t-5t), 10kg (10t-50t), 50kg (100t)
Power supply voltage	VDC	3.0 ... 4.8 (3 accumulators or primary cells AA) or powering by USB-Port
Power input (without illumination)	W	0.24
Battery life cycle with batteries incl.	h	approx. 40
Operating temperature range	°C	-10 ... +50
Storage temperature range	°C	-20 ... +70
Keypad		membran
USB interface		Mini-USB-B connector, 5 pin
Dimensions: (W x H x D)	mm	82.1 x 161.7 x 53.8
Weight without batteries	g	240
Environmental protection (EN 60529)		IP 54 in used position, USB-port closed
Functions: backlight, to tare, unit, maximum value, data transmission, accumulation		

All data according to VDI/VDE/DKD 2638

Dimensions

Load	A	B	C	D	E	F	Weight
1.0 t	190	118	∅ 14	151	16	38	1.1 kg
2.5 t	233	118	∅ 22	173	25	42	1.7 kg
5.0 t	250	118	∅ 27	180	30.5	45	2.1 kg
10 t	325	118	∅ 48	213	47	64	3.9 kg
20 t	378	141	∅ 55	233	57	74	6.8 kg
35 t	405	156	∅ 66	245	67	84	9.4 kg
50 t	450	180	∅ 76	264	77	94	14.4 kg
100 t	640	260	∅ 100	380	99	113	39.3 kg

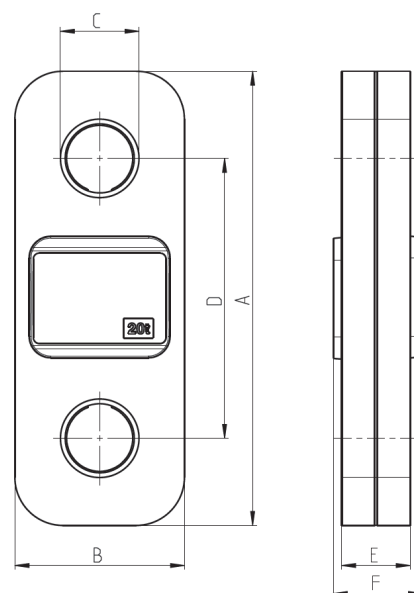

Ordering Example

KAK-F/20t/0.2	Load link with remote controll 20t
	Accuracy class
	Capacity
	Model (incl. Transportbox)

Type Code / Options

XK 107 Charger for 1-4 accumulators (without accumulators) **Batteries - AA** Rechargeable batteries AA, NiMH (indiv. ordered)
XKW 222 Works-calibration for KAK-F/1t ... 20t tension force
XKW 242 Works-calibration for KAK-F/35t ... 100t tension force
 Spacers for clearance compensation in shackles